



**DTC-2000-1 Remote Dog Training  
Collar  
Operation Guide**



## **DTC-2000-1 Dog Training Collar Operation Guide**

Thank you for choosing DTC-2000-1 Remote dog training collar. Our mission is to offer the best electronic training solutions. We want to ensure your dog's safety by providing you with the tools and techniques to successfully train your pet. Please feel free to contact us if you have any problems and we will resolve them immediately.

**Please read the complete operation guide carefully before starting to train your dog including the FAQ.**

### **IMPORTANT SAFETY INFORMATION**

#### **Not for Aggressive Dogs.**

*Do not use this product if your dog is aggressive, or if your dog is prone to aggressive behavior. Aggressive dogs can cause severe injury or even death to their owners and others. If you are unsure if this product is appropriate for your dog, please consult your veterinarian or certified trainer.*



## CAUTION

*Please read and follow the instructions in the manual. Proper fit of the collar under the dog's neck is important. A collar worn for too long or made too tight on your dog's neck may cause skin damage or irritation. This can range from redness to pressure ulcers; commonly known as bed sores. Training collars can cause pressure necrosis if used incorrectly and is often misidentified as burns.*

 *The temperature of environment must be higher than 0 °C when charging. The ideal charging temperature is between 10-45 °C.*

1. Avoid leaving the collar on the dog for more than 8 hours out of every 24 hours and try to re-position the collar on your dog's neck every 1 to 2 hours if possible.
2. Check the fit of the collar to prevent excessive pressure; follow the instructions in the manual.
3. Never connect a lead to the electronic collar; it could cause excessive pressure on the contacts.
4. When using a separate collar for a lead, don't put pressure on the electronic collar.

5. Wash the dog's neck area and the contacts of the collar weekly with a washcloth and mild soap, then rinse thoroughly.

6. Examine the contact area daily for signs of a rash or a sore. Brushing the coat daily may help.

7. If a rash or sore is found, discontinue use of the collar until the skin has healed.

8. If the condition persists beyond 48 hours, see your veterinarian.

***These steps will help keep your pet safe and comfortable. Millions of pets are comfortable while they wear stainless steel contacts. Some pets are sensitive to contact pressure and it is important to continue daily checks of the contact area. If redness or sores are found, discontinue use until the skin has fully healed.***

***Training sessions which are shorter and more positive (10-15 minutes) are often the most effective.***

 ***Do not use the collar on a dog that is under 10lbs or 6 months of old.***

Improper or inappropriate use of a training collar system can be harmful. Please use this product correctly and pay attention when training your dog.



# TABLE OF CONTENTS

CONMponents.....	5
HOW TO THE SYSTEM WORKS.....	6
MAIN FEATURES.....	7
TRANSMITTER.....	8
RECEIVER.....	12
KEY POINTS TO NOTE.....	14
SETTING UP MULTI DOG SYSTEM.....	15
MATCH A RECEIVER.....	15
OPERTATE HIGH LIGHT LED.....	17
CANCEL A MATCHED RECEIVER.....	18
FIT THE RECEIVER.....	20
CHARGING.....	21
TRAINING GUIDE.....	22
HOW DOGS LEARN.....	25
FREQUENTLY ASKED QUESTIONS.....	29
TROUBLESHOOTING GUIDE.....	33

# COMPONENTS



Lanyard



Spanner



Long Prongs



Transmitter



Test light



Rubber Prongs



Receive Collar



USB Car Charger



TPU Strap



USB Cable



5V DC Adaptor





# HOW TO THE SYSTEM WORKS

The DTC-2000-1 dog trainer has been proven safe, comfortable, and effective for all pets over 10 pounds and 6 months old. This system assists you in controlling your pet without a leash in a long distance range. At the push of a button, the remote transmitter sends a signal, activating the receiver collar. Using the remote trainer consistently and correctly, many misbehaves that your pet exhibits can be corrected or any basic obedience commands can be taught.

 ***Important: The remote trainer actual distance is dependent on the way you hold the remote transmitter, the range may vary. Hold the remote transmitter in a horizontal position away from your body to achieve optimum range. Terrain, weather, vegetation, vehicles, buildings, transmission from other radio devices, and other factors will affect the range of your remote trainer.***

# MAIN FEATURES

- - Range in open field up to 2000 meters.
- -Highlight LED function can find pet from 200~300 meters away at night.
- - Train up to 2 dogs from the same transmitter.
- - 99 levels each of static shock.
- - momentary and continuous shock
- - “Beep” sound activated with a separate button.
- - Vibration activated with a separate button.
- - Rotation switch allow you to set your intensity
- - Dog selection button allow you to select your dog.
- - LED display for shock levels& training mode & dog ID&Battery level
- - Memorize shock level in transmitter for different dogs.
- - Easy to operate with rubber button.
- - Waterproof transmitter and receiver. Dogs can swim freely.
- - Rechargeable 3.7V Li-ion battery for transmitter and receiver.
- -Strong TPU Collar Strap.
- - LED low power indication, red light will flash when battery level is low.
- - Full functional multi-dog training system.
- - Around 8 seconds safe static shock protection.
- - Comes with warranty.



# TRANSMITTER BUTTON FUNCTIONS

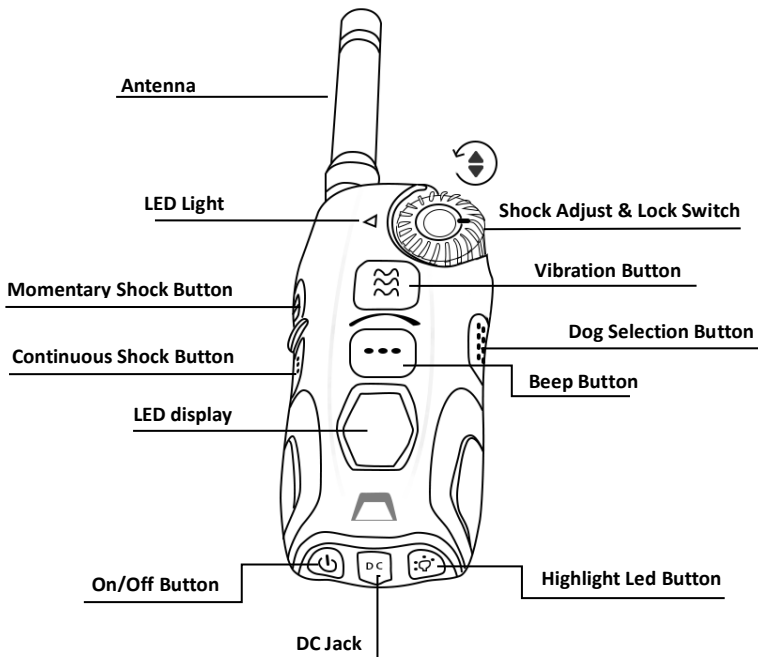



### ➤ **On/Off button**

Hold this button for 2 seconds to switch on power, then LED will display the default "01".

You may change Dog ID by move the Dog Selection Button.

Hold this button for 2 seconds to switch off power.

### ➤ **Dog selection button**

Move up to choose first dog , The LED screen display "1" ;

Move down to choose second dog, the LED screen display "2".

### ➤ **Shock Adjust&Lock Switch**

Rotate the switch to adjust the shock intensity from levels 0 to 99

Press the switch to lock the shock level , press the switch again to

unlock the shock level.

### ➤ **Vibration button**

Vibration stimulation. Press 1 time- vibrate 1 time.

Press and hold on- emit continuous vibration.

Will stop vibrating when you let go of the button.

Will stop automatically when you go past 8 seconds of holding the button.

### ➤ **Beep button**

No-stimulation warning beep

## ➤ **Led light**

Indicates the working status and low battery

## ➤ **Highlight Led buttons**

Press one time , the receive collar led flash 1 time ;

Press and hold on button for 3 seconds , the receive collar will highlight flash 5 times then flash 1 time per 3 seconds continuously.

## ➤ **Momentary shock button**

Momentary static shock.

## ➤ **Continuous shock button:**

Continuous static shock for about 8 seconds.

## ➤ **LED display**

Display the shock ,beep or vibration mode ; display shock level , lock or unlock shock status ,dog ID ,battery status

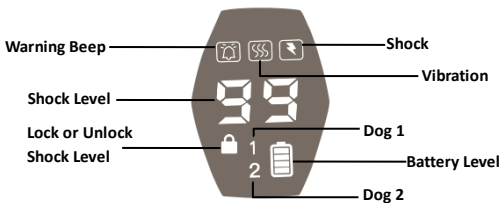

The transmitter has the memory functions to save the suitable shock



for different dogs. 99 levels of shock stimulation, 1 level of vibration stimulation. One tone.

➤ **DC Jack:**

Charging the transmitter .

 ***NOTE: The red LED light will flash when the battery is low on power. Recharge the battery at once.***

# RECEIVER BUTTON FUNCTIONS

**⚠ NOTE: CHARGE RECEIVER BEFORE FIRST USE. IF IT DOESN'T**

**CHARGE CONTACT US IMMEDIATELY**

## DC Jack Cover

Open the Rubber Cover and insert the adaptor plug into DC Jack to charge.

## Contact Prong

Choose short or long prong to match the dog's coat type.

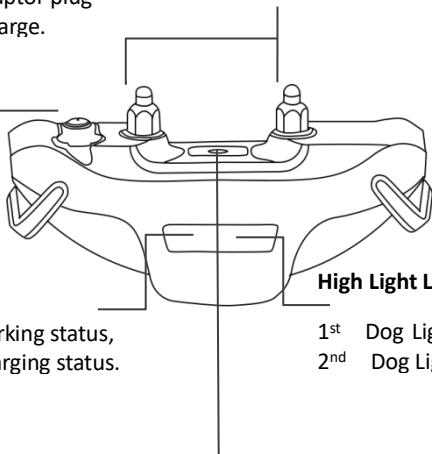

## LED Light

Indicate the working status, low battery, charging status.

## High Light Led

1<sup>st</sup> Dog Light = White  
2<sup>nd</sup> Dog Light = Red

## On/Off Button

**Turn On The Collar** = Press and hold on 4 seconds.

2 "beep" sounds and the collar green LED light will flash 1 time per 5 seconds if connected. The LED will flash fast if disconnected.

**Turn Off The Collar** = Press and hold on 4 seconds.

1 long tone will sound and the green LED light will stop flashing and turn off.



## Spanner

Change the Contact Prong depending on the pet's coat type.

***Note: If the contact prong is tight, don't continue to turn the spanner clockwise or the contact prong will be broken. Never turn the contact prong too tightly. Turn anticlockwise to loosen or remove.***

You can expand your one dog trainer to a multi-dog remote trainer by yourself. Simply purchase extra receiver collars and add them to your system.

** NOTE: IF THE COLLAR DOESN'T TURN ON PLEASE CONTACT US FOR A NEW BATTERY OR CHARGER.**

## KEY POINTS TO NOTE

1. Always charge before use. Ideal time to charge is 2-3 hours for the receiver as this is better for the life of the battery.

2. The on/off buttons need to be held down for several seconds to turn the units on and off

3. Only use the receiver for 8 in every 24 hours and adjust the collar every 1-2 hours if possible to make sure it is correctly placed and not causing irritation.

4. If the receiver won't connect to a specific number on the remote, try a different number as this does sometimes happen.

5. Rapid flickering of the green LED means the receiver is disconnected.

6. The receiver is still waterproof without the rubber stopper in place. This does not affect performance.

7. You may use any collar with the receiver as long as it

fits correctly.

# SETTING UP MULTI DOG SYSTEM

## ❖ PAIR A RECEIVER

To add a receiver collar to your remote dog training system, following the below steps.

**Only turn on 1 collar at a time to connect.**

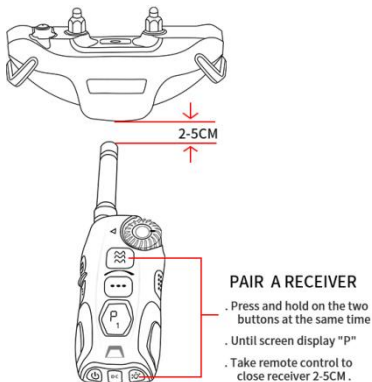

**STEP 1:** Take out 1 unmatched receiver collar. Press and hold the On/Off Button. The Receiver Indicator Light will come on and then turn on after " 2 beep" sounds.



**(NOTE: If the Receiver Indicator Green Led Light begins flashing fast, repeat this step.)**

Take out the transmitter that you want to match to the receiver. Press and hold on the “” button until LED display occurs then release, the transmitter is now on.

*(NOTE: Never open 2 or more unmatched receivers at the same time.)*

**STEP 2:** If you want to match the 1<sup>st</sup> dog , please choose first dog ,The LED display “1”

If you want to match the 2<sup>nd</sup> dog , please choose the second dog , the LED display “2”

**STEP 3:** Hold the transmitter close to the unmatched receiver 1 to 2 inches away. Press and hold the **Vibration button**  and **Highlight Led button**  at the same time until the LED display is “P”. Not to release the 2 buttons.

**STEP 4:** Once hearing 5 “beeps” sound from the receiver. The receiver matched and will begin flashing Green Led Light once every 4-5 seconds. Then release the button.

*(NOTE: If the receiver didn't connect, please repeat the STEP3 to STEP 4. Try to close to the receiver from different direction and more close.)*

**STEP 5:** Test matched Receiver Functions

Press Vibration button, Beep button to test the reaction of receiver collar. Press stimulation button to test receiver by Test Light

1. Insert the contact points into the Test Light.
2. Press a stimulation button on the remote transmitter.
3. The Test Light will flash.
4. Turn the collar receiver off.
5. Save the Test Light for future testing.

***Note: If the Test Light does not flash, recharge the battery and re-test.***

If you need, you can also put it on the lowest setting and test on the back of your hand/arm for confirmation if you're still unsure.

## ❖ **OPERATE HIGH LIGHT LED**

Your remote trainer has 2 colors(white, red ) of high light LED. You can find out your pets from 200-300 meter away in dark night without remote control.

***To get highlight flash in dark night , you must match the receive collar to transmitter first .***

Press **Highlight Led button** of Transmitter one time , the receive collar will highlight flash 1 time per 3 seconds continuously.



Press **Highlight Led button** again ,The highlight LED will be on ,  
Then Press **Highlight Led button** again ,The highlight LED will be off .

***You match different dog receive collar , you can get different high light flash .***

The 1<sup>st</sup>dog = White highlight Led

The 2<sup>nd</sup>dog =Red highlight Led

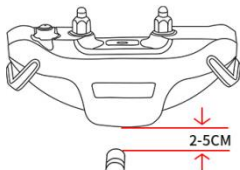

## ❖ **UNPAIR A RECEIVER**



### **UNPAIR A RECEIVER**

- . Press and hold on the two buttons at the same time
- . Until screen display "U"
- . Take remote control to close receiver 2-5CM .

**STEP 1:** Turn On the matched Receiver and transmitter.

**STEP 2:** Hold the transmitter next to the receive collar 1 to 2 inches away. Press and hold the **Beep Button**  and **Highlight Led Button**  at the same time, until the LED display is “U” . Not to release the two buttons.

**STEP 3:** Once hearing 5 “beep” sounds from the receiver. The receiver unmatched and will begin flashing Green Led Light frequently. Then release the button.

 ***If the receiver didn't cancel the match, please repeat the STEP 2 to STEP 3 . Try to close to the receiver from different direction and more close.***

# FIT THE RECEIVER

**To ensure a proper fit, follow these steps:**

1. With your dog standing (3A), center the Collar Receiver so the Contact Points are underneath your dog's neck, touching the skin (3B). If your dog has a long or thick coat, you have two options to ensure consistent contact: either trim the hair around the Contact Points or switch to the longer Contact Points included with your system.

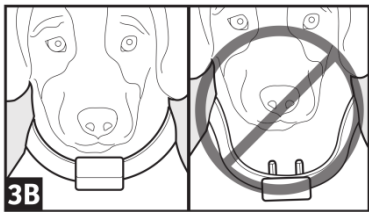
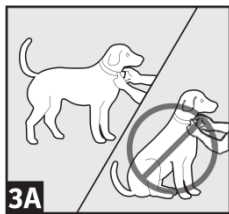

2. The Collar Receiver should fit snugly, yet loose enough to allow one finger to fit between the strap and your dog's neck (3C).

3. Allow your dog to wear the collar for several minutes, and then recheck the fit. Check the fit again as your dog becomes more comfortable wearing the Collar Receiver.

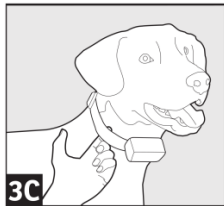

# CHARGING

 ***Do not charge batteries in hot or too cold areas, keep far away from fire.***

1. Lift the rubber cover protecting the DC Charging Jack.
2. Connect the corresponding charge connector to the DC Charging Jack.
3. Plug the USB Adaptor into a power source.
4. Charge the Remote Transmitter for 2 hours for the first charge and every charge thereafter.

***Using Li-Ion technology, the Transmitter and receiver only requires a 2 hour charge. It is not harmful to let the unit charge for more than 2 hours.***

## **1. Receiver collar charging**

The Red LED Light Flashing=Lower Power

The Red LED light is on=Charging

The Green LED light is on= Full Charged (Charger still connected)

## **2. Transmitter Charging**

The Red LED Light Flashing=Lower Power

The Red LED light is on=Charging

The Green LED light is on= Full Charged (Charger still connected)

 ***NOTE: IF THE RECEIVER AND TRANSMITTER DOESN'T TURN ON PLEASE CONTACT US FOR A NEW BATTERY OR CHARGER.***



# TRAINING GUIDE

## ❖ INTENSITY SELECTION TIPS

The correct intensity for training is normally one that will motivate the dog, but not overwhelm. Dogs are like people in that they all have individual sensitivity levels. Also, different types of training call for different levels of intensity. So it's wise to test your dog to find the correct intensity level before you start training.

**IMPORTANT:** For best results when finding your dog's sensitivity, use continuous stimulation. If your transmitter has more than one button for continuous stimulation, use the button for the lowest level when finding your dog's sensitivity.

 **NOTE:** *If your dog overreacts (vocalizes or acts "rattled") when you use the lowest level of continuous stimulation that's available on your collar model, then retest for sensitivity starting with the lowest level of momentary stimulation.*

*If your dog doesn't respond up to level 40, check to see if the receiver is snug against your dog's neck and start again from level 1.*

*If you still have no luck in getting a response, you have two options: trim the hair beneath the receiver or switch to the longer prongs. After all these steps if you are still having problems email us.*

## **Choosing the Appropriate Length of Contact Points**

This is a critical STEP and is often overlooked. If you don't have the proper length contact points, the collar won't work correctly. For smaller dogs, the short contact points should be used. For larger dogs, or dogs with a heavier hair coat, you should use the longer contact points. You may trim the hair if the coat is too thick but never shave completely as this may lead to a rash or infection.

## **❖ General Training Tips**

1. Make training sessions short and positive (between 10-15 minutes long for each session.)
2. Train one dog at a time.
3. During the first initial training sessions, keep the dog in a familiar outdoor environment.
4. Use a long leash fastened to a non-metallic collar to help the dog's learning.
5. Be consistent. Give your dog a tone and/or stimulation with each misbehave.
6. Teach the dog a command first before reinforcing the command with the remote transmitter.
7. Issue one obedience command at a time. Do not use the training system for commands that the dog has not learn.

8. Do not over correct your dog. Use as few simulations as possible to train your dog.

9. During training, look for all the positive changes in the dog's behavior and remember to reinforce them promptly with ample praise and reward.

10. If you notice one situation in which your dog misbehaves repeatedly, set up this situation as a training session. This will dramatically increase your chances of success.

11. If your dog has a timid reaction to the tone or stimulation (especially the first couple of times), do not be alarmed. Redirect his attention to a simple and appropriate behaviour (i.e. a known command such as "sit").

12. Please keep in mind, that you should keep training sessions short and end every session on a high note. Stop training and play with the dog as soon the dog has accomplished a new level of proficiency.

13. Never use the DTC-2000-1 Dog Training Collar to correct or eliminate any form of aggressive behaviour. If your dog exhibits such behaviour, contact a professional trainer. Aggression in dogs is the result of many factors- it may be a learned behaviour or it may be brought on as a result of fear. Another factor contributing to aggression in dogs is social dominance. Every dog is different.



# HOW DOGS LEARN

Here are some basic guidelines that cover all your remote trainer work on obedience commands.

- **Follow a STEP-by-STEP introduction process on each command.** Don't assume that your dog will understand a remote trainer correction in connection with a command. The stimulus can confuse them initially, even if they know the command.

- **Don't introduce remote training with too high of an intensity level.** Use a level that is just high enough to cause your dog to respond to it after repetition. Do not introduce the collar at such a high level that your dog becomes worried or is vocalizing. The intensity level of remote trainers can be adjusted for a wide range of breeds and temperament types.

- **Don't introduce remote training around distractions.** Keep things simple for your dog in their first sessions. They can't learn well when there's too much going on.

## ❖ Learning to Train

Every animal on the planet has an alpha or beta relationship with every other animal. We usually think of “beta” as submissive and beaten down, but in wild packs or herds, that is not the case. The beta dog in a pack of wild dogs is still quite happy and lives a good life. So your dog should live the comfortable life – while remaining in the beta position. Your dog will be quite happy being beta as long as you show the dog that beta is a good way to live. In dog terms, you are the “alpha,” giving your dog everything it needs to survive. The essentials of food, shelter, and most importantly, companionship (the pack) are provided by you. For those things, your dog will work and be happy as long as you demonstrate that you will not submit to challenges.

To be sure, the beta dog will present regular challenges in hopes of gaining the alpha position. If the beta dog wins the challenge, there is a new leader of the pack, so do not give in. Some of the challenges are subtle. Those are the ones you must pay close attention to while training. If you win the small battles, the big fights will be much easier to handle. Dogs see the world in black and white. To your dog, either you are in control or it is. There is no middle ground.

There are two most important points, **conditioned responses** and **substitution**, will be the cornerstones of your training program.

**Conditioned responses** to commands are mandatory for a properly trained dog. When you explain something one time to a person, he or she will understand it and quite often give a positive response when questioned on that topic. Canines are different in that they trust their instincts implicitly. Instincts have protected canines for thousands of years from wild animals and other threats, and those threats still live in their minds today. In your training program, you must totally condition the responses to the obedience commands to such a degree that your dog trusts you more than its own instincts. That is a tall order, and you must take it seriously or you will not have success. Simple repetition is the only way to properly condition a dog. Simple repetition to the tune of around 1,000 repetitions per command will do this nicely. That might seem like an undoable task but if you will train consistently, it will take only a short time.

**Substitution:** This is where we use a stimulus to cause a response and then add another stimulus simultaneously until the

second stimulus evokes the same response as the first. You might remember Dr. Pavlov's work with ringing the dinner bell as he was feeding his dog. It did not take long before simply ringing the dinner bell caused the dog to salivate. You will use this same practice in training your dog, beginning with a leash, progressing to words and then finishing with electrical stimulation. It may sound overwhelming right now but you will be successful and your dog will accept this without question if you follow the steps.

# FREQUENTLY ASKED QUESTIONS

## **Is the stimulation safe for my dog?**

While the stimulation is unpleasant (it produces a static shock like we sometimes experience as humans), it is harmless to your dog. These devices also require interaction and training from the owner to achieve desired results.

## **Is the collar waterproof?**

Yes, they are designed to be completely waterproof. Any problems please email us for a faster or similar response time.

## **If the rubber stopper comes away from the charging port, is the collar and remote still waterproof?**

Yes, this makes no difference to the waterproof status of the device, though keep in place if possible to keep debris out and for peace of mind.

## **How old should my dog be before I use this device?**

It is recommended that your dog be 6 months old to use a training collar. Your dog should have learned the basic commands such as “sit” or “stay”.

## **How big does my dog need to be to use this device?**

Your dog needs to be over 10lbs to use this device.

## **The collar doesn't fit my dog, what should I do?**

If the collar doesn't fit your dog you can remove the receiver and put it on to a collar that does fit your dog ok.

## **The collar is too long, is it ok to cut off the excess collar?**

Yes

## **Once my dog is trained, do I still need to use the collar?**

This is up to you, you can keep the collar on for insurance, or only wear it in high risk environments. If your dog is completely trustworthy now you can choose either way. You may also just use it from time to time as a reinforcement or as a refresher for certain behaviors.

## **Can I use this on my aggressive dog?**

We do not recommend any of our products to be used on aggressive dogs. In this situation please contact your local veterinarian or professional trainer to determine if your dog might be aggressive.

## **Will I get exactly the 2000 meters range as advertised?**

Testing for the 2000 meters range is performed in perfect conditions. The range you get will vary according to terrain, weather, vegetation, as well as, transmission from other radio devices. For best results make sure the collar has the light closest to the dog's nose and you hold the remote horizontally and away from your body.

## **How long can I give continuous stimulation to my dog?**

You can hold down the vibration or shock button for up to 8 seconds before the safety feature kicks in and it stops. You then need to press the button again if you want to shock for up to 8 seconds again.

### **What do I do if on the off chance my dogs neck becomes red and irritated?**

This is due to the contact points irritating the skin. Discontinue use for a few days. If the condition persists beyond 48 hours, see your veterinarian. Once the skin returns to normal, resume use and monitor the skin condition closely. You should be checking regularly for irritation as every dog responds differently.

### **Can I use a leash with the training collar on?**

DO NOT attach a leash to the training collar. You may use a separate non-metallic collar on your dogs neck and attach a leash. Be sure the extra collar does not interfere with the contact prongs.

### **How do I know if the collar is working?**

Use the test light that comes with your device. Set up the collar then match the prongs to the metal strip on the test light. You then press the shock to see if the button lights up. If they do then the collar is ready to go.

### **Can I test the collar on the back of my hand or arm?**

This is up to you and we take no liability for this action. Some people

choose to do this so they can feel the intensity that the dog is experiencing. The lower levels might not be felt by you depending on your sensitivity.

**Will this work automatically when my dog barks?**

No, you need to press a button to control the device.

**How many dogs can I set up on this system?**

2 Dogs, you need to purchase extra collars if needed.

**Do I need to set up the collar every time I use it?**

No, even though it is quick once you know what you are doing, it has a memory function and saves your last settings and remains connected unless you have disconnected the collar.

**How long does the battery last?**

The length of time the battery lasts between charges depends on how much you use the device. If used often it will need to be charged every other day like a mobile phone. The batteries are designed to last 3-5 years if used regularly. Any problems please contact us and we can send a replacement.



# TROUBLESHOOTING GUIDE

## **Problem#1: No stimulation when a transmitter button is pressed.**

- The receiver has not been activated. The receiver must be turned on otherwise it won't work at all.
- The receiver has not been matched to your transmitter. Follow the instructions to match.

## **Problem#2: The beeper of receiver doesn't make any sound when the receiver is turned on.**

- Press dog selection button to choose correct dog ID before pressing

## **Problem#3: The stimulation seems too high, not high enough or no feeling at all**

- The collar strap is not tight enough. Make sure the contacts points connect to the dog's skin well.

- The intensity level is not correct. Change the level.
- The batteries are dead. Recharge as needed.

**Problem#4: The receiver light changes color to indicate low battery very quickly**

- The unit has been left turned on in between training session. Make sure the receiver is turned off after use.
- You are training in very cold weather.

**Problem#5: The remote trainer doesn't have range or the range is significantly reduced.**

- Either you or the dog is shielded by a metal structure. Operate it far away from these structures.
- The receiver is on backwards. For best range, position the receiver so that the light faces toward the dog's nose.
- Radio interference. Wait a short while then try again, or move to another area.

**Problem#6: The receiver can't receive any signal or cannot work at all**

- Check the receiver on/off button, make sure the receiver is turned on.
- Check the receive collar green Led , make sure it flash 1 time of 5 seconds.
- Check the transmitter, if it has a low battery, charge transmitter first.
- The battery is broken, please contact us and we will send you a replacement battery. The batteries are specifically designed for this model.
- The charger is broken, please try in your computer.
- Cancel the receiver match, then re-match it with the transmitter.



**MGG Products, Kerikeri, New Zealand**  
**[www.mggproducts.co.nz](http://www.mggproducts.co.nz)**